

GEORGE T. DUNHAM  
SURVEYING & SUBDIVIDING  
DELAVER, WISCONSIN

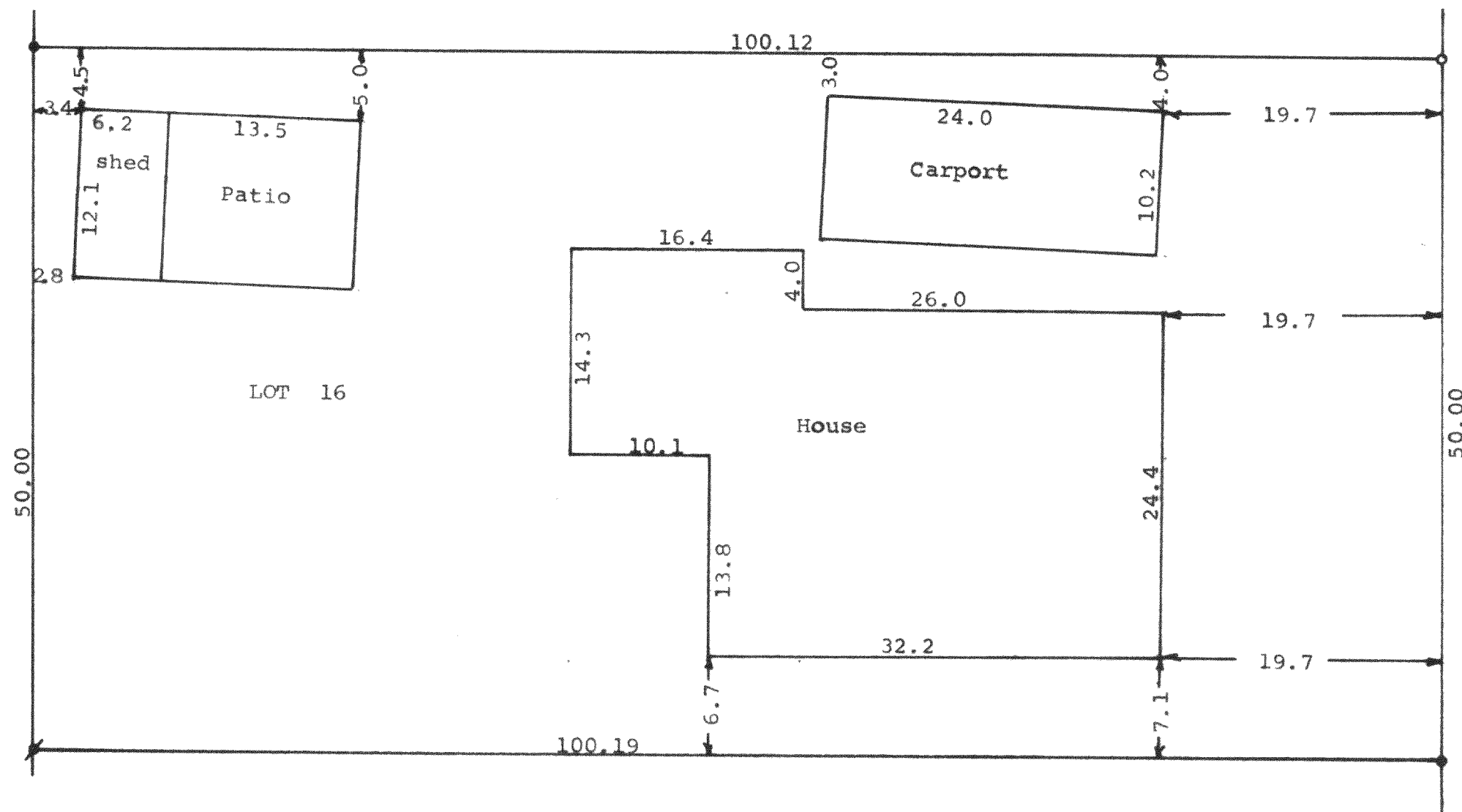

DORIS STREET

N

Scale - 1" = 10'  
 • = Iron Pipe Set  
 • = Iron Pipe Found  
 • = Wood Stake or mark in subsoil found and Iron Pipe Set

STATE OF WISCONSIN)  
COUNTY OF WALWORTH)SS

I, George T. Dunham, Surveyor, certify that I have surveyed the property described as follows,

Lot 16 of Hillside Subdivision located in Section 5, T 1 N, R 16 E, Walworth County, Wisconsin,

and the above map is a true representation thereof and shows the size and location of the property, its exterior boundaries, the location and dimensions of all structures thereon, fences, apparent easements and roadways and visible encroachments, if any.

This survey is made for the exclusive use of the present owners of the property, and also those who purchase, mortgage, or guarantee the title thereto within one (1) year from date hereof; and as to them I warrant the accuracy of said survey and map.

July 8, 1976

*George T. Dunham*  
George T. Dunham, Surveyor

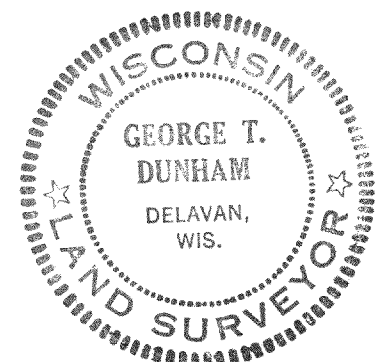

EH-11

Lot 16 Hillside

116-133